

REVISION HISTORY				
REV	DESCRIPTION	ECN	DATE	APPROVED
C	ISSUED FOR PRODUCTION		14AP00	NN

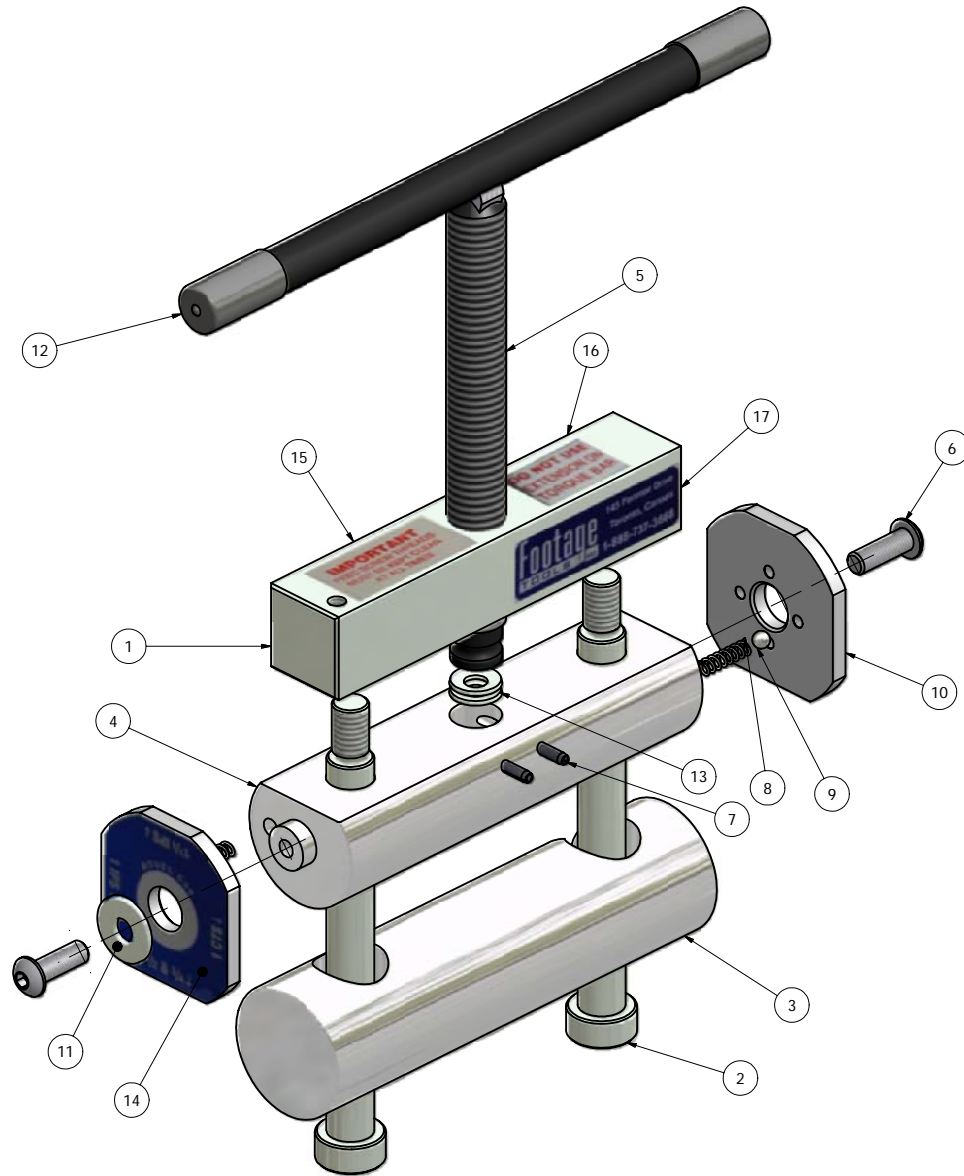

NOTES:

- 1) APPLY LOCTITE #242 ON ITEM NUMBER 1 & 6
- 2) LUBRICATE WITH MOLYSLIP#3352 ON ITEMS 5 & 13

Parts List			
QTY	PART NUMBER	DESCRIPTION	ITEM
1	-	OWNERS MANUAL - C50	19
1	BOX-C50	SHIPPING / STORAGE CONTAINER	18
1	LABEL-01	LABEL, FOOTAGE TOOLS NAME PLATE	17
1	LABEL-001	LABEL, DO NOT USE EXTENSION	16
1	LABEL-00	LABEL, FEED SCREW	15
2	C50-08	GAUGE PLATE LABEL	14
2	C50-10	SPRING WASHER	13
2	C50-23	PLUG	12
2	C50-11	WASHER	11
2	C50-07	GAUGE PLATE	10
2	99-157-00-0006	CHROME BALL	9
2	C100-21	SPRING	8
2	99-163-00-0816	ROLL PIN	7
2	99-104-00-0408	BHCS 1/4-20 X 1/2" LG	6
1	C50-06	POWER SCREW ASM	5
1	C50-02-	SLIDING BAR	4
1	C50-03	STATIONARY BAR	3
2	C50-09	SIDE SHAFT - PLATED	2
1	C50-01	TOP BAR	1

DRAWN nguyenj	6/3/2009	FOOTAGE TOOLS INC.		
CHECKED				
QA		TITLE		
MFG		C50-A1 ASSEMBLY DWG		
APPROVED nguyenj		1/2 - 1 - 1/4" SQU. OFF TOOL		
REMOVE ALL SHARP CORNERS UNLESS SPECIFIED OTHERWISE		SIZE C	DWG NO C50 Assembly	REV C
SCALE	NTS	SHEET 1 OF 1		